

Close Tactical Select Passive Conservative Fund

Task Force on Climate-related
Financial Disclosures
(TCFD) Aligned Product Report

2023

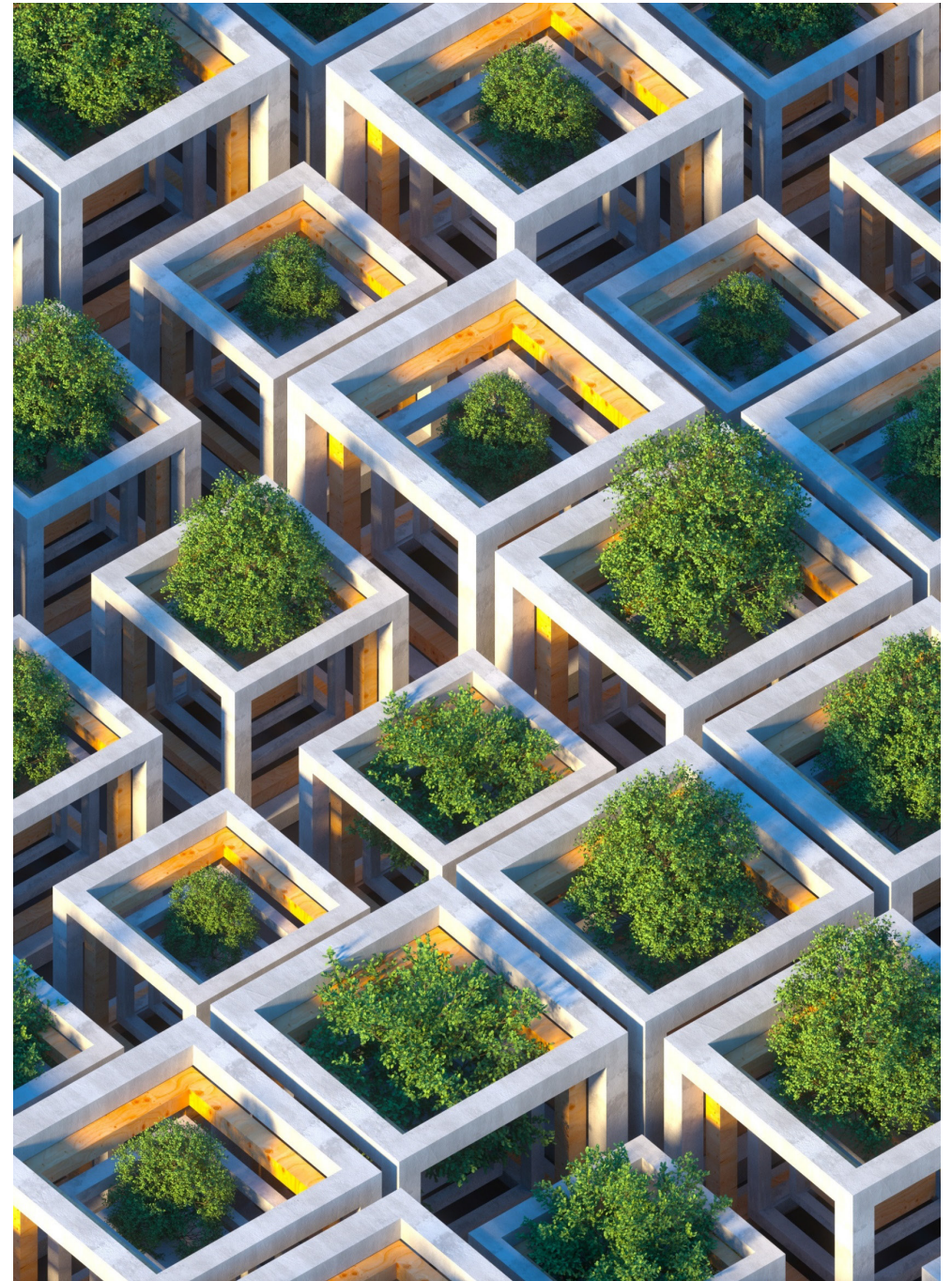

Close Tactical Select Passive Conservative Fund

A sub-fund of Close Discretionary Funds unit trust (ISIN: GB00B7FHXB62).

This Fund is managed by Close Asset Management (UK) Limited.

This *TCFD* Aligned Product Report is in alignment with UK regulatory standards and reflects Close Brothers Asset Management's strategy as detailed in the *TCFD* Aligned Entity Report.

This report provides detailed information regarding the emissions produced by the companies or issuers within the Fund. For a thorough understanding, it is recommended that this report be read in conjunction with our *TCFD* Aligned Entity Report.

This Fund's approach to governance, strategy and risk management does not materially deviate from our overarching approach. For ease of understanding, a glossary is included at the end of this report defining all terms which are in *italics*.

All data shown is as at 31 July 2023.



Fund summary

The objective of this Fund is to deliver moderate capital growth with some income over the medium term (i.e. more than five years).

The Fund will hold at least 80% of its portfolio in a mixture of equities and fixed interest securities, achieving this exposure almost exclusively through investment in passively managed collective investment schemes (which may include collective investment schemes managed by the Manager or by an affiliate of the Manager) and exchange traded funds.

The Fund is actively managed, with the manager employing a strategic asset allocation model (developed in collaboration with an external provider) that is matched to a specific risk and volatility band.



Data provider

We use MSCI as the sole provider for all emissions and climate data in this report, aiding uniformity in our emissions calculations.

We rely on MSCI for the accuracy of emissions data for our public investments. Not all assets have emissions data available and the percentage of assets where we have data is shown in the table on page 3.

When reported emissions data is unavailable for some assets, MSCI applies a specific estimation method. If no reported or estimated emissions data is available from MSCI, we do not employ an alternative internal estimation method.

Close Tactical Select Passive Conservative Fund

A sub-fund of Close Discretionary Funds unit trust (ISIN: GB00B7FHXB62)

This Fund is managed by Close Asset Management (UK) Limited

Data coverage

Metric	Coverage % (ex-cash)*	Asset classes covered
Financed emissions	0	Funds
Weighted Average Carbon Intensity (WACI)	0	Funds
Implied Temperature Rise (ITR)	60	Funds
Policy climate VaR	0	Funds
Tech opps climate VaR	0	Funds
Physical climate VaR	0	Funds

*Cash = ~2% of the total portfolio net asset value and is excluded from the calculation of asset coverage.

Climate metrics against portfolio comparator

The Fund's comparator is comprised of 40% MSCI All Countries World Index and 60% Bank of America Global Corporate Bond Index.

Metric	Fund	Comparator	Relative
Scope 1 & 2 GHG Financed Emissions (tCO2e)	n/a	n/a	-
Scope 3 GHG Financed Emissions (tCO2e)	n/a	n/a	-
Total GHG Footprint (tCO2e/£mil invested)	n/a	672	n/a
WACI Scope 1 & 2 (tCO2e/£mil sales)	n/a	262	n/a
WACI Scope 3 (tCO2e/£mil sales)	n/a	1,085	n/a

tCO2e = tonnes of carbon dioxide equivalent.

WACI = Weighted Average Carbon Intensity.

GHG = Greenhouse Gas Emissions.

The Fund is invested in collective investment schemes rather than listed equities or corporate bonds. We currently do not have sufficient data coverage for this investment type to provide commentary on the emission metrics of the Fund or to provide an analysis of the fund's overall exposure to climate-related risks.

Scenario analysis

Our approach to *scenario analysis* involves assessing the exposure of our equity and corporate bonds holdings using MSCI's Climate Value at Risk (CVaR) methodology.

Furthermore, this analysis is based on a snapshot of holdings as of 31 July 2023 and does not consider action to mitigate risk, such as engagement or asset reallocation.

The portfolio's aggregated CVaR is a weighted aggregation of each security's CVaR.

The analysis allows us to identify companies which are particularly exposed to transition or *physical risks*, and which are exposed to policy risks and likely to benefit from low-carbon technology opportunities.

The scenarios have been developed by the *Network for Greening the Financial System (NGFS)* and are widely accepted as appropriate in the financial services industry.



1.5°C
Orderly

Limits global warming to 1.5 degrees by 2050. An orderly scenario assumes policies are introduced early and gradually.

1.5°C
Disorderly

Limits global warming to 1.5 degrees by 2050. A disorderly scenario assumes policies are delayed resulting in higher risk.

2.0°C
Orderly

Limits global warming to 2.0 degrees by 2050. An orderly scenario assumes policies are introduced early and gradually.

2.0°C
Disorderly

Limits global warming to 2.0 degrees by 2050. A disorderly scenario assumes policies are delayed resulting in higher risk.

3.0°C
Hot House World

Current policies are preserved. Emissions grow until 2080 leading to 3°C+ of warming and severe physical risks.

The Fund's overall CVaR can be calculated based on an average or aggressive *physical risk* scenario. The average scenario is the most likely physical impact of climate change, whereas the aggressive scenario has a 1 in 20 chance of occurring.

The results presented represent estimates of possible future scenarios, not precise forecasts. These climate models rely on multiple assumptions which are uncertain and therefore the projections could deviate significantly from reality.

Climate Value at Risk (CVaR)

We are currently unable to run reliable scenario analysis for this fund.

Aggregated Climate VAR (%)

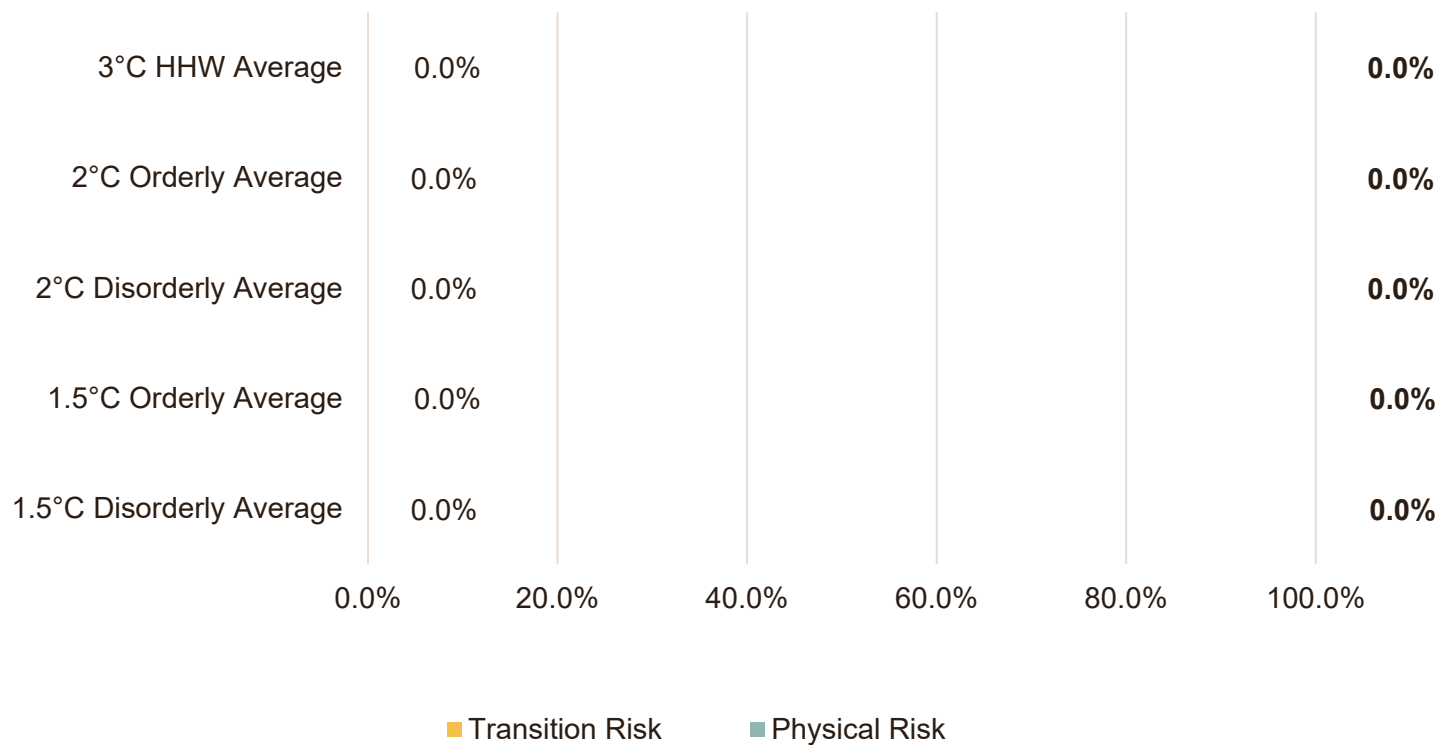

The majority of the fund's constituents are in collective investment schemes, which limits the applicability of the available MSCI data. This gap prevents us from accurately modelling the potential impacts of various climate scenarios on the fund.

Implied Temperature Rise

The *Implied Temperature Rise (ITR)* metric provides an indication of how well public companies align with the Paris Agreement – the goal of limiting global temperature rise this century to well below 2°C above pre-industrial levels and to pursue efforts to limit the temperature increase even further to 1.5°C.

The key to understanding *ITR* is the concept of a carbon budget, that is, how much the world can emit so that global warming doesn't exceed 2°C by 2100 and, by extension, how much a company can emit to take its fair share of global decarbonisation.

To arrive at an *ITR* for a company, its emissions are compared against its assigned carbon budget, and the entire economy is then assumed to have the same carbon budget overshoot or undershoot.

The deviations from the budget are then converted to °C.

The portfolio-level *ITR* uses an aggregated budget approach: it compares the sum of 'owned' projected *GHG* emissions against the sum of 'owned' carbon budgets for the underlying portfolio holdings.

The portfolio's total estimated carbon budget over or under shoot is then converted to a degree of temperature rise (°C) using *science based Transient Climate Response to Cumulative Emissions (TCRE)*.

The metric used to define ownership is *Enterprise Value including Cash (EVIC)* in order to enable the analysis of equity and corporate bond portfolios.

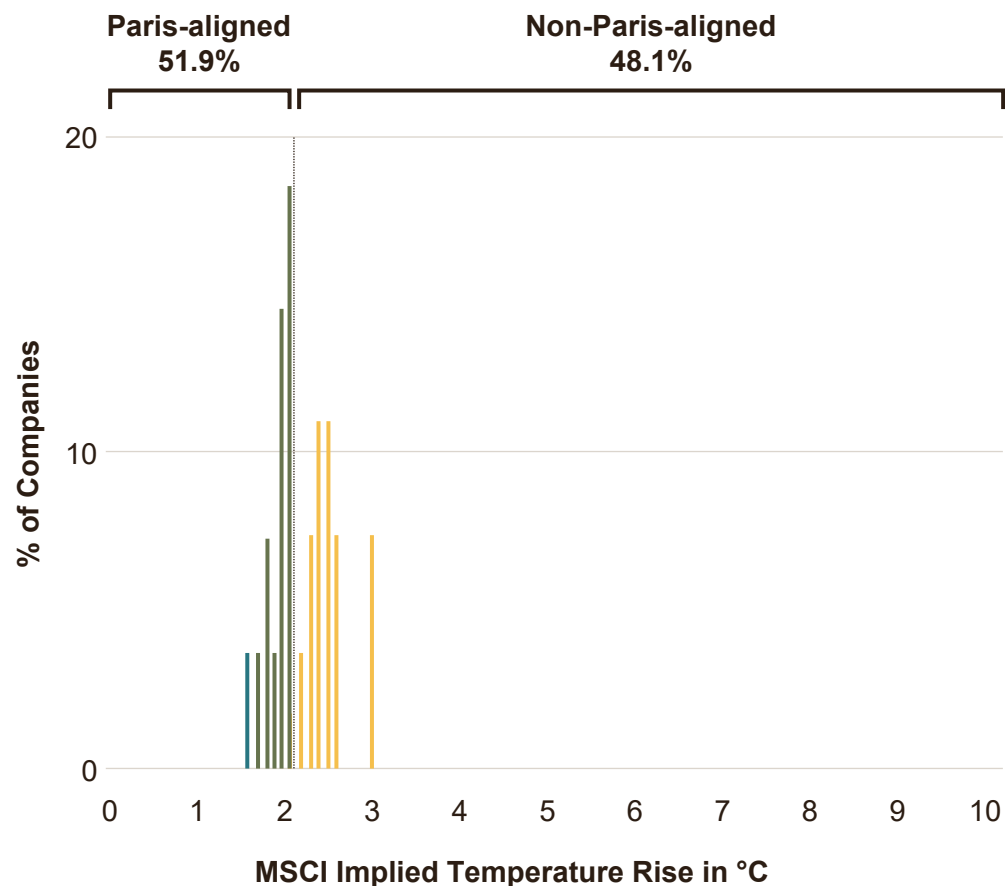

The issuers in the portfolio are distributed according to their *ITR* showing the number who are aligned with the Paris Agreement, including the more ambitious 1.5°C temperature goal.

Implied Temperature Rise

ITR categories	Companies
1.5°C Aligned	3.7%
2.0°C Aligned	48.1%
Misaligned	48.1%
Strongly misaligned	0.0%

Portfolio	ITR
Passive Conservative	2.2°C

51.9% of funds within the portfolio align with the goal of limiting temperature increase to below 2°C.

3.7% of funds within the portfolio align with the goal of limiting temperature increase to below 1.5°C.

The portfolio implied temperature is greater than 2.0°C but there are no holdings with *ITRs* above 3°C.

Glossary

Climate scenarios	A description of possible future climate change pathways. Climate scenarios are used to assess the potential impact of climate change on businesses and other organisations.	Implied Temperature Rise (ITR)	The amount of global warming that is implied by an organisation's total carbon emissions. Implied temperature rise is calculated by plotting an organisation's total carbon emissions and trajectory against a carbon budget (typically a global carbon budget broken down into sector-region allocations). The global carbon budget is the amount of carbon emissions that can be emitted without exceeding a certain temperature target.
Disorderly	Refers to a chaotic and poorly managed transition to a lower-carbon economy, characterised by significant economic disruption and financial market instability.	Net zero	Net zero refers to a state in which emissions of GHG going into the atmosphere are matched by removal of GHG emissions out of the atmosphere, over a specified period. The 'net' in net zero is important because it will be difficult to reduce all emissions to zero on the required timescale. As well as deep and widespread cuts in emissions, there will likely be a need to scale up GHG removals.
Enterprise Value Including Cash (EVIC)	The total value of a company including its cash, all equity ownership and debt.	Weighted Average Carbon Intensity (WACI)	WACI measures a portfolio's exposure to carbon intensive companies. Calculating a portfolio's WACI is achieved by calculating the carbon intensity (scope 1 and 2 emissions / \$M Sales) for each portfolio company and calculating the weighted average by portfolio weight.
Financed emissions	The emissions attributed to financing activities; for Close Brothers Asset Management financed emissions is the proportion of investee emissions for which Close Brothers Asset Management are responsible based on the number of shares or bonds held in the company or issuer.		
Greenhouse Gas (GHG) Emissions	Greenhouse gases are gases in the atmosphere that trap heat from the sun, causing the Earth's temperature to rise. The most common greenhouse gases are carbon dioxide (CO ₂), methane (CH ₄), nitrous oxide (N ₂ O), hydrofluorocarbons (HFCs), perfluorocarbons (PFCs), sulphur hexafluoride (SF ₆), and nitrogen trifluoride (NF ₃). These will all usually be converted into their carbon dioxide equivalent (CO ₂ e) to allow comparison between the different gases.		

Glossary

Network for Greening the Financial System (NGFS)	An international network of central banks and financial supervisors that are working to promote sustainable finance. The NGFS have developed a set of climate scenarios tailored to financial sector companies.	Scope 2 emissions	Indirect GHG emissions that occur from the generation of purchased electricity, steam, heat, and cooling.
Orderly	Refers to a smooth and well-managed transition to a lower-carbon economy, minimising economic disruption and ensuring stable financial markets.	Scope 3 emissions	All other indirect GHG emissions that occur in the value chain of an organisation. This can include emissions from transportation of goods and services, and use of sold products and services.
Physical risk	The financial risks resulting from climate change-related physical events, such as extreme weather events and long-term shifts in climate patterns.	Task Force on Climate-related Financial Disclosures (TCFD)	The TCFD is an international body that was set up by the Financial Stability Board to develop recommendations for companies to disclose climate-related financial information.
Scenario analysis	The process of analysing the potential impact of different climate scenarios. Scenario analysis is used to help organisations make decisions about how to manage climate-related risks and opportunities.	Total GHG footprint	The GHG footprint of a financial portfolio is a measure of the total carbon dioxide equivalent emissions associated with the assets held in the portfolio. It is calculated by dividing the total emissions of the assets in the portfolio by the value of the portfolio.
Science based	Refers to targets or strategies that are aligned with the latest climate science to meet the goals of the Paris Agreement, aiming to limit global warming to well below 2°C above pre-industrial levels.	Transient Climate Response to Cumulative Emissions (TCRC)	The transient climate response to cumulative emissions of carbon dioxide is the ratio of the globally averaged surface temperature change per unit carbon dioxide emitted.
Scope 1 emissions	Direct GHG emissions that occur from sources that are owned or controlled by an organisation. This may include emissions from fuel combustion for heating, power generation and transportation.		

Disclaimers

This report includes certain data and analyses provided by MSCI Inc. (MSCI).

The information provided by MSCI is intended solely for informational purposes and does not constitute investment advice.

MSCI data and reports are sourced from publicly available information and proprietary content.

The use of MSCI data is subject to the terms and conditions as stipulated by MSCI.

Any dissemination or reliance on this information by third parties is strictly prohibited.



Data limitations

We are aware that emissions data often includes estimations or proxy data, thereby data coverage of our portfolio's exposures or risks is subject to a margin of error. We are committed to persistently enhancing the precision of our data utilisation. However, it is crucial to highlight that the outcomes derived should be regarded as indicative rather than definitive.

Scope 3 emissions

Our scope 3 emissions, presently do not account for financed emissions associated with the assets under the stewardship of Close Brothers Asset Management. It is our strategic objective to methodically extend our disclosures to encompass all critical emissions categories. Yet, our immediate emphasis is on fortifying our data framework to afford our clients with reliable and indicative emissions insights.

Assets covered

Our reporting covers public listed equities and corporate bonds. This is credited to the superior quality and reliability of data associated with these asset.

Scope 1, 2 and 3

In our TCFD Aligned Entity Report, we disclose scope 1, 2, and 3 emissions, confident in the appropriateness and reliability of the data for these purposes. However, it is important to note that within our fund prospectuses, we report only scope 1 and 2 emissions. The omission of scope 3 emissions from these prospectuses is deliberate, as we do not consider the available scope 3 data robust enough to inform our sustainable investment methodology. This distinction reflects our commitment to accuracy and transparency in our sustainability reporting.



Close Brothers Asset Management is a trading name of Close Asset Management Limited (Registered number: 01644127) and Close Asset Management (UK) Limited (Registered number: 02998803). Both companies are part of Close Brothers Group plc, are registered in England and Wales and are authorised and regulated by the Financial Conduct Authority. Registered office: 10 Crown Place, London EC2A 4FT. VAT registration number: 245 5013 86.

Source of all data is Close Brothers Asset Management as at 31 July 2023 unless otherwise specified.

CBAM 13270. June 2024